

RoHS Compliant

REV.	ECN NO.	DESCRIPTION	REVISER	DATE

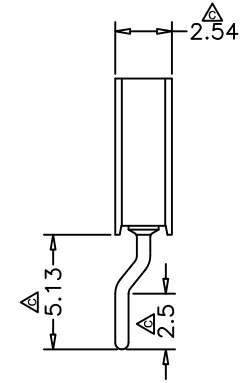
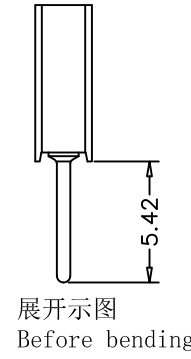
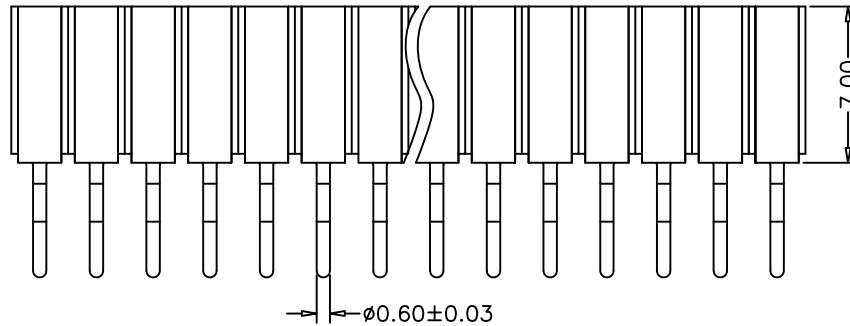
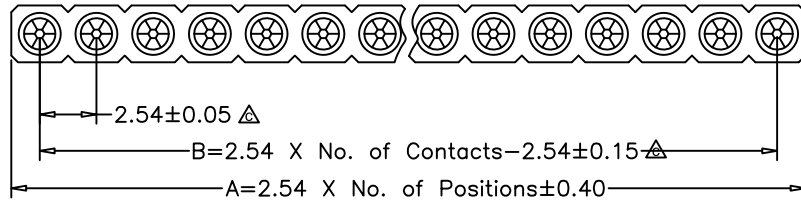

Technical Data

Material:
 Pin(outer sleeve): Brass,machined CuZn38Pb2
 Clip(contact 6 finger): Beryllium Copper,heat treated
 Plating(outer sleeve):
 Tin plated:4~5µm/200µ"Sn over 2µm/80µ"Ni
 Gold Plated:gold full over 2µm/80µ"Ni
 Plating(contact): gold or Tin plated over 2µm/80µ"Ni
 Insulator(black): Glass filled thermoplastic polyester
 UL94V-0

Electrical:
 Current rating: 3Amps/contact max.
 Contact resistance: ≤4mΩ/contact
 Insulation resistance: ≥1000MΩ at V=100V
 Operating voltage: 60VAC/DC

Mechanical:
 Average insertion force : <250g
 with steel pin of Ø0.7mm-Ø0.8mm or SQ0.64mm
 Average withdrawal force : >50g
 with steel pin of Ø0.7mm-Ø0.8mm or SQ0.64mm
 Mechanical life cycle:min.200
 Operating temperatures: Gold Plsted:-55°C to+105°C
 Tin plated:-40°C to+105°C
 Soldering temperature: +260°C,10s max.

CRITICAL DIMENSIONS: Δ

Ordering information

4RM254S - XX GT - 1243A

No. of Contacts 02~40PINS
 Plating Option
 G1 Gold 1µ"for clip and sleeve
 T0 Tin 150µ"for clip and sleeve
 GT Gold 1µ"for clip Tin 150µ"for sleeve

THIRD ANGLE PROJECTION ALL DIMENSIONS ARE IN MM TOLERANCE UNSPECIFIED X. ±0.30 X.X ±0.25 X.XX ±0.15 X.XXX ±0.05 X.° ±2° X.X° ±1° X.XX° ±0.5°	DRAWN BY: FB.YANG	 深圳市多维鑫电子有限公司 SHENZHEN TORVENICS ELECTRONIC CO.,LTD.	
	CHECKED BY: GH.PANG		TITLE: 2.54mm SIP Socket Single row 90° SMT
	APPROVED BY: TONY.OU	DATE: 03/19/2013	PART NUMBER: 4RM254S-XX-GT-1243A
	SHEET: 1 OF 1	SCALE: 3:1	
REV.: 01	SIZE: A4		