

RoHS Compliant

REV.	ECN NO.	DESCRIPTION	REVISER	DATE

Technical Data

Material:

Pin(outer sleeve): Brass,machined CuZn38Pb2
 Clip(contact 4 finger): Beryllium Copper,heat treated
 Plating(outer sleeve):
 Tin plated:2μm/80μ"Ni, 5μm/200μ"Sn
 Gold Plated:2μm/80μ"Ni,Full gold
 Plating(contact): 2μm/80μ"Ni, gold or Tin plated
 Insulator(black): Glass filled thermoplastic polyester
 UL94V-0

Electrical:

Current rating: 3Amps/contact max.
 Contact resistance: ≤4mΩ/contact
 Insulation resistance: ≥1000MΩ at V=100V
 Operating voltage: 60VAC/DC

Mechanical:

Average insertion force with steel pin of
 Ø0.43mm/0.17": <50g
 Average withdrawal force with steel pin of
 Ø0.43mm/0.17": >15g min.
 Mechanical life cycle:min.200
 Operating temperatures: Gold Plated:-55°C to+105°C
 Tin plated:-40°C to+105°C

CRITICAL DIMENSIONS: \triangle

No. of Positions	DIM"A"	DIM"B"
20	18.28	16.002
24	21.836	19.558
28	25.392	23.114
40	36.06	33.782
42	37.838	35.56
48	43.172	40.894
52	46.728	44.45
56	50.284	40.894
64	57.396	55.118
68	60.952	58.674

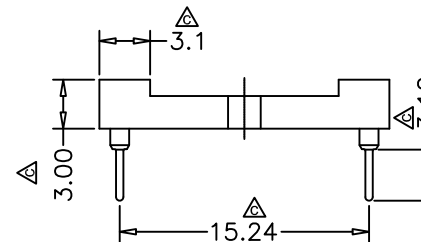
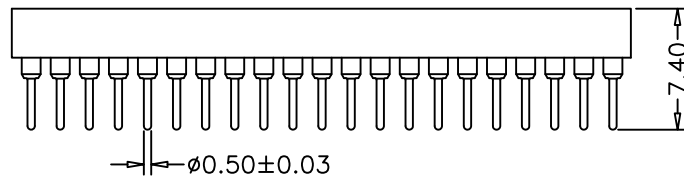
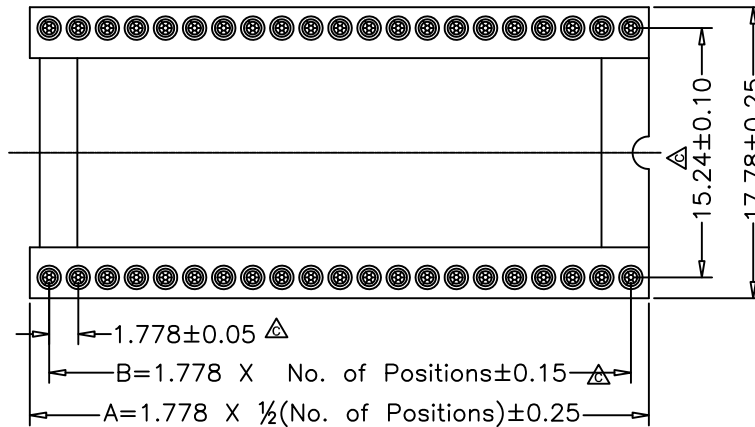

Ordering Information

4S1778D-XX-6-GT-0740A

No. of Contacts
20~68pins

Plating Option

G1 Gold 1μ" over nickel
 T0 Tin 150μ" over nickel
 G3 Gold 3μ" over nickel
 G5 Gold 5μ" over nickel
 GT Tin for sleeve gold 1μ"for clip

THIRD ANGLE PROJECTION		DRAWN BY: FB.YANG		 深圳市多维鑫电子有限公司 SHENZHEN TORVENICS ELECTRONIC CO.,LTD.
		CHECKED BY: GH.PANG		
ALL DIMENSIONS ARE IN MM		APPROVED BY: TONY.OU		TITLE:
TOLERANCE UNSPECIFIED		DATE: 03/19/2013		Socket Connector 1.778mm,SIP S/T ,0.6" L=7.40mm
X. ±0.35		SHEET: 1 OF 1		PART NUMBER:
X.X ±0.20		SCALE: FIT		
X.XX ±0.15		REV.: 01		4S1778D-XX-6-GT-0740A
X.XXX ±0.05		SIZE: A4		
X.° ±2°		X.X° ±1°		
X.XX° ±0.5°				