

RoHS Compliant

| REV. | ECN NO. | DESCRIPTION | REVISER | DATE |
|------|---------|-------------|---------|------|
| | | | | |
| | | | | |

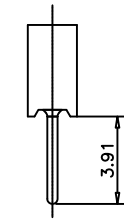

展开示图

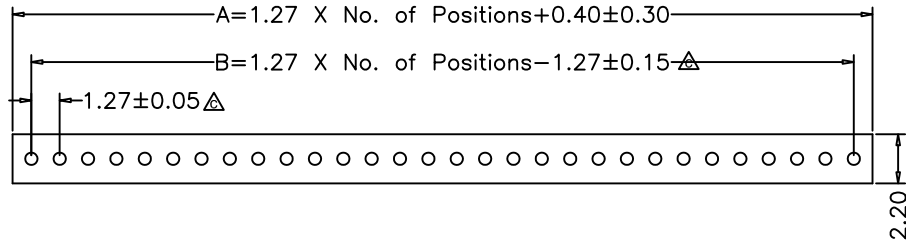
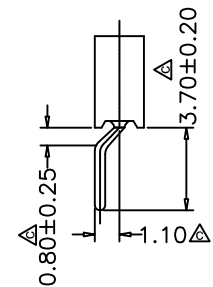
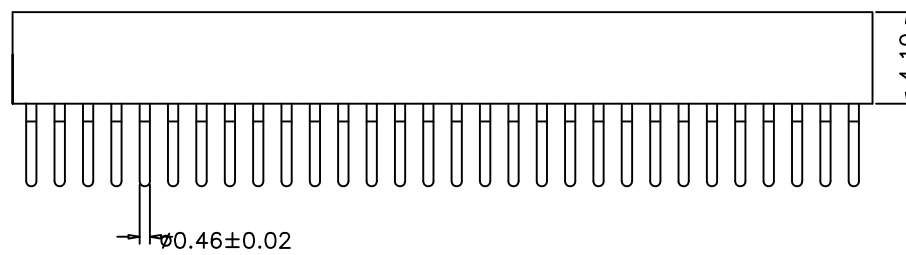

Technical Data

Material:

Pin(outer sleeve): Brass,machined CuZn38Pb2

Clip(contact 6 finger): Beryllium Copper,heat treated

Plating(outer sleeve):

Tin plated:2μm/80μ"Ni, 5μm/200μ"Sn

Gold Plated:2μm/80μ"Ni,Full gold

Plating(contact): 2μm/80μ"Ni, gold or Tin plated

Insulator(black): Glass filled thermoplastic polyester
UL94V-0

Electrical:

Current rating: 1Amps/contact max.

Contact resistance: ≤4mΩ/contact

Insulation resistance: ≥1000MΩ at V=100V

Operating voltage: 60VAC/DC

CRITICAL DIMENSIONS: Δ

Recommended PCB Board Hole Layout

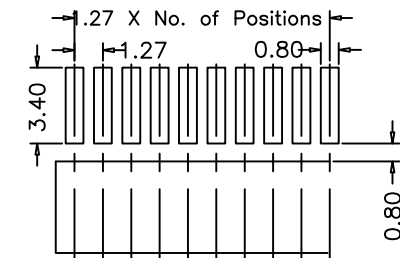

Ordering information

4RM127S-XX-GT-0760A

No. of Contacts
02-50pins

Plating Option

- G1 Gold 1μ"for clip and sleeve
- T0 Tin 150μ"for clip and sleeve
- GT Gold 1μ"for clip Tin 150μ"for sleeve

generic use

| | | |
|---|------------------------|--|
| THIRD ANGLE PROJECTION ALL DIMENSIONS ARE IN MM TOLERANCE UNSPECIFIED X. ±0.35 X.X ±0.20 X.XX ±0.15 X.XXX ±0.05 X.° ±2° X.X° ±1° X.XX° ±0.5° | DRAWN BY: FB.YANG | 深圳市多维鑫电子有限公司 SHENZHEN TORVENICS ELECTRONIC CO.,LTD. |
| | CHECKED BY: GH.PANG | |
| APPROVED BY: TONY.OU | DATE: 03/19/2014 | PART NUMBER: 4RM127S-XX-GT-0760A |
| SHEET: 1 OF 1 | SCALE: 3:1 | REV.: 01 |
| SIZE: A4 | | |